

PD006006

Gearbox Specifications

Outer diameter	6mm	Bearing	Porous bearing	Rolling bearing
Material	Plastic	Axial endplay	≤0.3mm	≤0.3mm
Direction of rotation	cw & ccw	Radial loading on output shaft	≤0.3N	≤4N
Gear backlash	≤3°	Operating temperature range	-20 ~ +85°C	

Gearbox Stages

	1	2	3	4
Reduction ratio	5 / 6	23 / 31 / 41	110 / 148 / 198 / 266	531 / 711 / 952 / 1275 / 1708
Max rated torque of gearbox (gf.cm)	250	250	250	250
Instant torque of gearbox (gf.cm)	600	600	600	600
Gearbox efficiency (%)	85	72	57	49
Gearbox length L1 (mm)	9.7	12.1	14.5	16.9

Technical Drawing

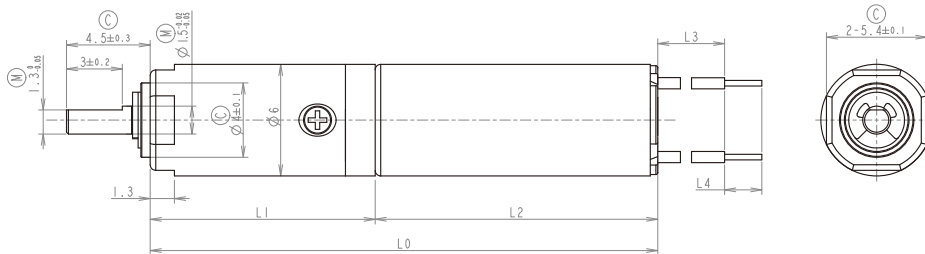

Motor Specifications

Motor type (optional)	Coreless motor, Stepper motor	Input speed	≤3000rpm
Voltage (optional)	3-12V	Current	100mA max

Model	Rated Speed	Max Speed	Max Rated Torque	Max Instant Torque	Reduction Ratio	Gearbox Length	Overall Length
	rpm	rpm	gf.cm	gf.cm		mm	mm
PD006006-5	1563	6250	250	600	4.8	9.7	23.7
PD006006-6	1166	4666	250	600	6.43		
PD006006-23	326	1302	250	600	23.04	12.1	26.1
PD006006-31	243	972	250	600	30.86		
PD006006-41	181	726	250	600	41.33		
PD006006-110	68	271	250	600	110.6	14.5	28.5
PD006006-148	51	203	250	600	148.1		
PD006006-198	38	151	250	600	198.4		
PD006006-266	28	113	250	600	265.7		
PD006006-531	14	57	250	600	530.8	16.9	30.9
PD006006-711	11	42	250	600	711.0		
PD006006-952	8	32	250	600	952.2		
PD006006-1275	6	24	250	600	1275.2		
PD006006-1708	4	18	250	600	1707.9		

*Please contact us for customized products